

Schedule 12 Part A

Regulation 33,34

Premises Licence

Premises Licence Number

1600242GLPRMG

Part 1 – Premises Details

Postal address:

**One Stop Shop
107 Southgate Street
Gloucester
GL1 1UU**

Telephone number
Where the licence is time limited the dates

Not applicable

Licensable activities authorised by the licence and the times the licence authorises the carrying out of licensable activities

Sale of Alcohol	Sunday	08:00 - 00:00
Sale of Alcohol	Monday to Thursday	08:00 - 23:00
Sale of Alcohol	Friday/Saturday	08:00 - 00:00

The opening hours of the premises

Monday to Thursday	08:00 - 23:00
Friday to Sunday	08:00 - 00:00

Where the licence authorises supplies of alcohol whether these are on and / or off supplies

Alcohol is supplied for consumption off the Premise

PUBLIC PROTECTION

Part 2

Name, (registered) address, telephone number and email (where relevant) of holder of premises licence

**Saied Osanlou
Flat 1
335 High Street
Cheltenham
Gloucestershire
GL50 3HS**

Registered number of holder, for example company number, charity number (where applicable)

Name, address and telephone number of designated premises supervisor where the premises licence authorises for the supply of alcohol

**Bahram Jafari
22 Westlecot Road
Old Town
Swindon
SN1 4HB**

Personal licence number and issuing authority of personal licence held by designated premises supervisor where the premises licence authorises for the supply of alcohol

881090074PERSON

Licensing Authority: Swindon Borough Council

Signature of Issuing Officer:



**Food, Licensing & Markets Service Manager
Public Protection**

Date Licence First Granted 12 October 2011

Date of Issue: 01 March 2016

Issuing Authority:

The District of Gloucester City Council, The Docks, Gloucester GL1 2EQ

Annex 1 – Mandatory conditions

Where licence authorises supply of alcohol

No supply of alcohol may be made under this licence

- a. at a time when there is no designated premises supervisor in respect of this licence, or
- b. at a time when the designated premises supervisor does not hold a personal licence or his personal licence is suspended

Every supply of alcohol under this licence must be made or authorised by a person who holds a personal licence.

Below Cost Ban

A relevant person shall ensure that no alcohol is sold or supplied for consumption on or off the premises for a price which is less than the permitted price.

For the purposes of the condition set out in paragraph 1 -

- (a) 'duty' is to be construed in accordance with the Alcoholic Liquor Duties Act 1979(6)
- (b) 'permitted price' is the price found by applying the formula -

$$P \text{ equals } D + (D \times V)$$

where -

- (i) P is the permitted price,
 - (ii) D is the amount of duty chargeable in relation to the alcohol as if the duty were charged on the date of the sale or supply of the alcohol, and
 - (iii) V is the rate of value added tax chargeable in relation to the alcohol as if the value added tax were charged on the date of the sale or supply of the alcohol;
- (c) 'relevant person' means, in relation to premises in respect of which there is in force a premises licence -
- (i) the holder of the premises licence,
 - (ii) the designated premises supervisor (if any) in respect of such a licence, or
 - (iii) the personal licence holder who makes or authorises a supply of alcohol under such a licence;
- (d) 'relevant person' means, in relation to premises in respect of which there is in force a club premises certificate, any member or officer of the club present on the premises in a capacity which enables the member or officer to prevent the supply in question; and
- (e) 'value added tax' means value added tax charged in accordance with the Value Added Tax Act 1994(7)

Age Verification Policy

- (1) The premises licence holder or club premises certificate holder must ensure that an age verification policy is adopted in respect of the premises in relation to the sale or supply of alcohol.
- (2) The designated premises supervisor in relation to the premises licence must ensure that the supply of alcohol at the premises is carried on in accordance with the age verification policy.
- (3) The policy must require individuals who appear to the responsible person to be under 18 years of age (or such older age as may be specified in the policy) to produce on request before being served alcohol, identification bearing their photograph, date of birth and either –
 - a) A holographic mark, or
 - b) An ultraviolet feature

Annex 2 – Conditions consistent with the Operating Schedule

A CCTV system with minimum 4 colour cameras recording at a frame rate of not less than 15 frames per second shall be maintained in good working order at the store and shall record at all times the premises are open. Recordings shall be kept for a minimum of 14 days and shall be produced within 3 days on request of Police, Trading Standards or Council Officers.

The 'Challenge 25' scheme (or equivalent) shall be adopted, so that any customer attempting to purchase alcohol who appears to be under the age of 25 years shall be asked for an accredited photographic proof of age (PASS approved card, passport or photo driving licence) and that a sale shall not be made unless this evidence is produced.

Spirits shall be displayed only behind the counter.

All staff are to be trained and will have a full knowledge of all licensing issues under the 2003 Licensing Act, including the 'Challenge 25' rule.

The premises will be monitored externally for anti-social behaviour, public nuisance and litter.

The premises will only accept trade deliveries or rubbish collections during normal working hours.

A refusals register will be kept and all refusals by any member of staff will be recorded. The register will be made available to Responsible Authorities on request.

Annex 3 – Conditions attached after a hearing by the licensing authority

None

Annex 4 - Plans

DRAWING SYMBOLS



Fire Exit



CCTV



Licensed Area

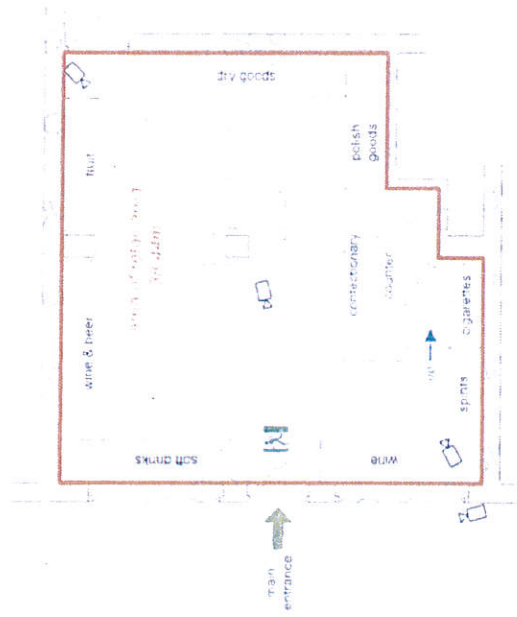

Project One Stop Shop
107 Southgate Street,
Gloucester, GL1 1UT

Drawing No. 002476
Drawing: Licensing Plan

Date 09.09.2011
Sheet 1 of 1

Do not scale off this plan

UK Surveyors Ltd
www.uksurveyors.net

djl@uksurveyors.net
Mobile 07814-452536
Office 01543-22915

Drawn By DLR
Scale 1:100 @ A4

Part B

Premises Licence Summary

Premises Licence Number

1600242GLPRMG

Premises Details

Postal address of premises, or if none, ordnance survey map reference or description, including Post Town, Post Code

One Stop Shop
107 Southgate Street
Gloucester
GL1 1UU

Telephone number

Where the licence is time limited the dates

Not applicable

Licensable activities authorised by the licence and the times the licence authorises the carrying out of licensable activities

Sale of Alcohol	Sunday	08:00 - 00:00
Sale of Alcohol	Monday to Thursday	08:00 - 23:00
Sale of Alcohol	Friday/Saturday	08:00 - 00:00

The opening hours of the premises

Monday to Thursday	08:00 - 23:00
Friday to Sunday	08:00 - 00:00

Where the licence authorises supplies of alcohol whether these are on and / or off supplies

Alcohol is supplied for consumption off the Premise

PUBLIC PROTECTION

Name, (registered) address of holder of premises licence

Saied Osanlou

Registered number of holder, for example company number, charity number (where applicable)

Name, designated premises supervisor where the premises licence authorises for the supply of alcohol

Bahram Jafari

State whether access to the premises by children is restricted or prohibited

Signature of Issuing Officer:



Food, Licensing & Markets Service Manager
Public Protection

Date Licence First Granted 12 October 2011

Date of Issue: 01 March 2016

Issuing Authority:

The District of Gloucester City Council, The Docks, Gloucester GL1 2EQ

1600242GLPRMG